

TIMBERTOWN ESTATE STAGE 8 FIFTH RELEASE

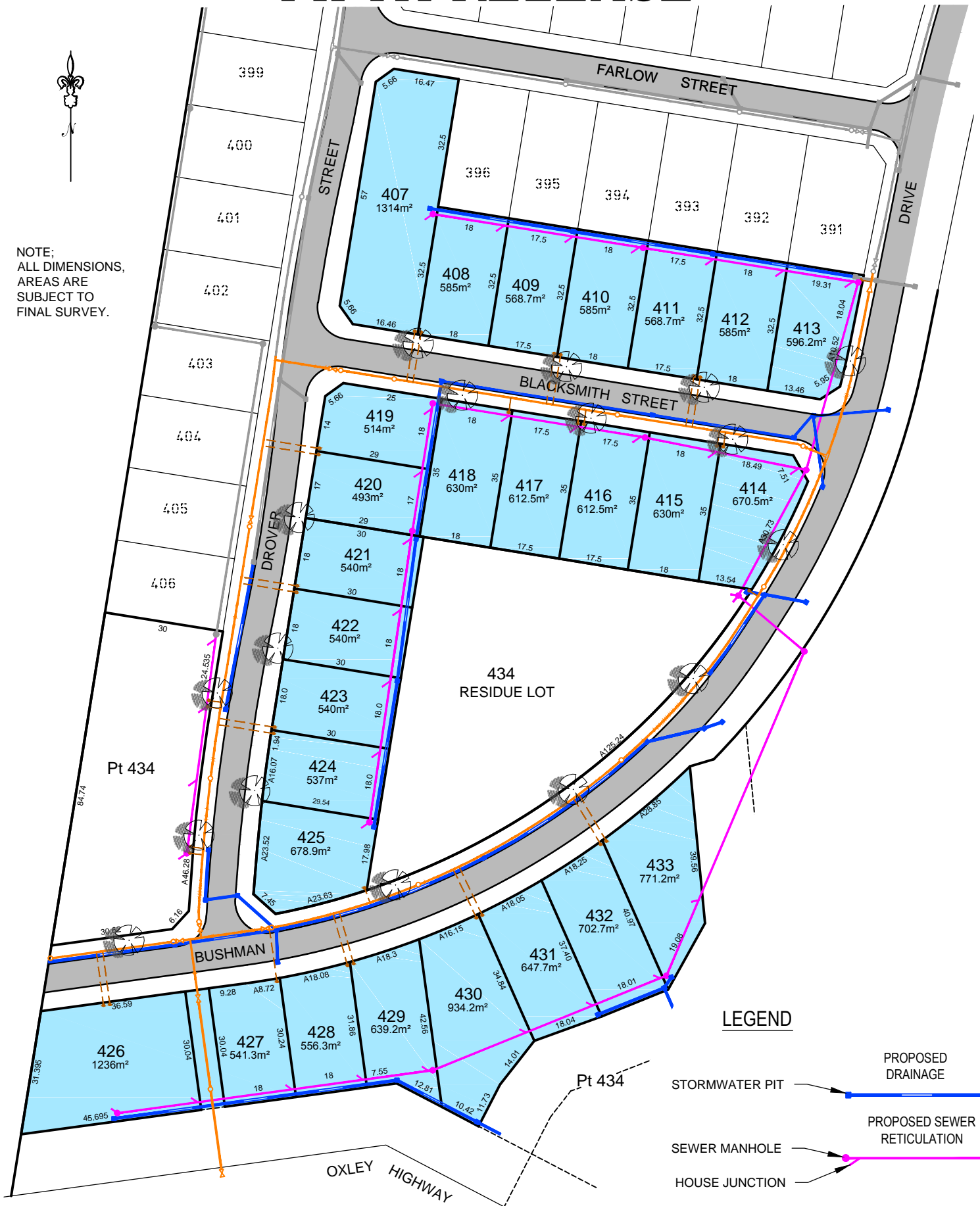

NOTE:
ALL DIMENSIONS,
AREAS ARE
SUBJECT TO
FINAL SURVEY.



LEGEND

- PROPOSED DRAINAGE
- PROPOSED SEWER RETICULATION
- SEWER MANHOLE
- HOUSE JUNCTION
- HYDRANT
- STOP VALVE
- HOUSE SERVICE
- STORMWATER PIT



Suite 1 / 109 William Street - PO Box 1556 Port Macquarie NSW 2444 - ABN 27 055 060 878
Telephone: 02 6583 6722 - Facsimile: 02 6584 9009 - Email: mail@hopcon.com.au

DEVELOPMENT MANAGERS · SURVEYORS · ENGINEERS · PLANNERS

NOVEMBER 2016